



### Type VUS/INC check valves

- Ball type

└─ Port size
**VUS/INC 14/Pa0,5**
  
└─ Opening pressure (bar)

Type	Selection 1	Selection 2	Nominal flow	Max. pressure	ports	weight
			l/min(US gpm)	bar(psi)		Kg(lb)
VUS/INC 14	PaXX	-	18 (4.5)	350 (5100)	All G1/4	0.01 (0.02)
VUS/INC 38			25 (6.6)	350 (5100)	All G3/8	0.02 (0.04)
VUS/INC 12			50 (13.2)	350 (5100)	All G1/2	0.04 (0.09)
VUS/INC 34			78 (20.6)	350 (5100)	All G3/4	0.07 (0.15)

Hydraulic diagram	Type	Execution	Operation/ Features	Max. flow up to		Max.press. up to	
				l/min	US gpm	bar	psi
	<b>VUS/INC</b>	ball type		78	20.6	350	5100

### Ordering codes and description

└─ Port size
**VUS/INC 14/Pa0,5**
  
└─ Opening pressure (bar)

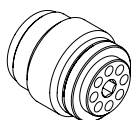

**Dimensions**

Dimensions are in mm-in

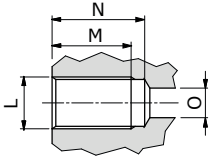
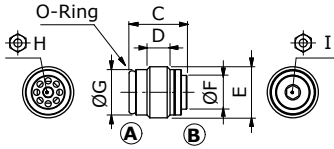

Valve type	ØC	D	E	G	ØG	⊕H	⊕I	O-Ring
<b>VUS/INC14</b>	17-0.67	6-0.24	G 1/4	9.2-0.36	11.3-0.445	3	3	1x9
<b>VUS/INC38</b>	18.5-0.73	7.5-0.29	G 3/8	11-0.43	14.8-0.57	3	4	1.78x10.82
<b>VUS/INC12</b>	23-0.90	9.5-0.37	G 1/2	14-0.55	18.5-0.73	5	6	1.78x14
<b>VUS/INC34</b>	28.5-1.12	14.5-0.57	G 3/4	19-0.75	24-0.94	8	8	2.62x18.72

Valve cavity for	L	M	N	O
<b>VUS/INC14</b>	G 1/4	25-0.98	28-1.1	8-0.31
<b>VUS/INC38</b>	G 3/8	27-.06	30-1.18	9-0.35
<b>VUS/INC12</b>	G 1/2	32-1.26	36-1.42	12-0.47
<b>VUS/INC34</b>	G 3/4	37-1.46	42-1.65	17-0.67

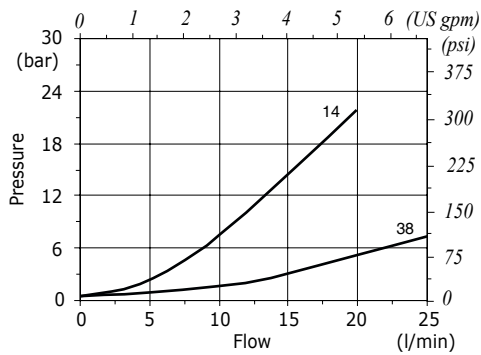
**Rating diagrams**
**VUS/INC14-38 pressure drop vs. flow**  
 opening pressure 0.5 bar (725 psi)

**VUS/INC12-34 pressure drop vs. flow**  
 opening pressure 0.5 bar (725 psi)
