

Type VRPSE..A. pilot operated check valves

- Single acting
- Shut-off
- DIN 2353

Port size ——— R - right
 L - left
VRPSE 01 A R

Type	Selection 1	Selection 2	Nominal flow	Max. pressure	ports	weight
			l/min(US gpm)	bar(psi)		Kg(lb)
VRPSE01A	R/L	-	25(6.6)	350(5100)	G1/4 P12	0.95(2.09)
VRPSE015A			25(6.6)	350(5100)	G3/8 P12	0.95(2.09)
VRPSE02A			50(13.2)	300(4350)	G3/8 P15	1.12(2.47)
VRPSE025A			50(13.2)	300(4350)	G1/2 P15	1.12(2.47)

Hydraulic diagram	Type	Execution	Operation/ Features	Max. flow up to		Max.press. up to	
				l/min	US gpm	bar	psi
	VRPSE..A.		single acting DIN2353 with shut-off	50	13.2	350 steel body	5100 steel body

Ordering codes and description

Port size ——— R - right
 L - left
VRPSE 01 A R

Selection 1

TYPE	DESCRIPTION
R	right
L	left

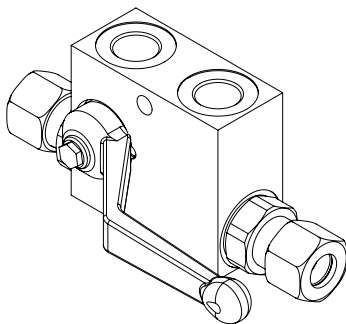

VRSE..A
Dimensions

Valve type	A1-U1	A2-U2 (Ø P)
VRPSE01A..	G1/4	12 0.27
VRPSE015A..	G3/8	12 0.27
VRPSE02A..	G3/8	15 0.59
VRPSE025A..	G1/2	15 0.59

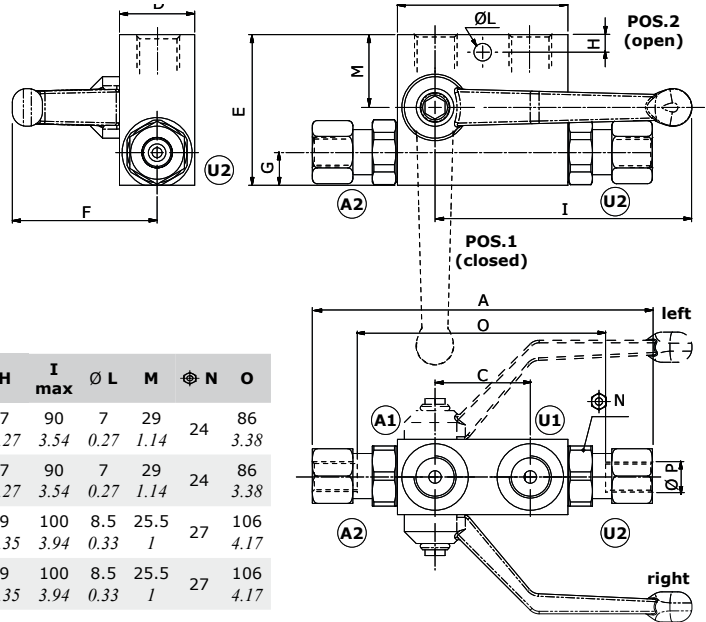

Dimensions are in mm-in

Valve type	A	B	C	D	E	F max	G max	H	I max	Ø L	M	⊕ N	O
VRPSE01A..	138	68	38	30	60	65	13	7	90	7	29	24	86
	5.43	2.68	1.50	1.18	2.36	2.56	0.51	0.27	3.54	0.27	1.14		3.38
VRPSE015A..	138	68	38	30	60	65	13	7	90	7	29	24	86
	5.43	2.68	1.50	1.18	2.36	2.56	0.51	0.27	3.54	0.27	1.14		3.38
VRPSE02A..	140	80	40	30	60	60	16	9	100	8.5	25.5	27	106
	5.51	3.15	1.57	1.18	2.36	2.36	0.63	0.35	3.94	0.33	1		4.17
VRPSE025A..	140	80	40	30	60	60	16	9	100	8.5	25.5	27	106
	5.51	3.15	1.57	1.18	2.36	2.36	0.63	0.35	3.94	0.33	1		4.17

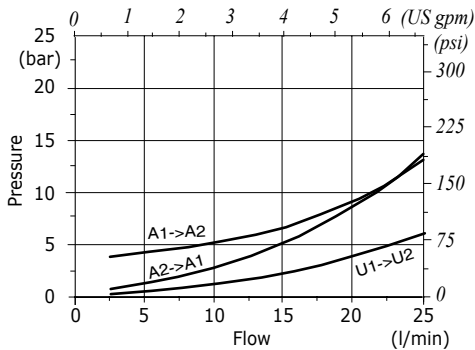
Rating diagrams
VRPSE01A pressure drop vs. flow

VRPSE02A pressure drop vs. flow
